

Presentation created by
Ashley Failing
(Parent/OLA Coordinator)

Outdoor Learning Areas

Guadalupe Elementary School

2022-2023

Acknowledge the Past → Plant with a Purpose → Plan for the Future

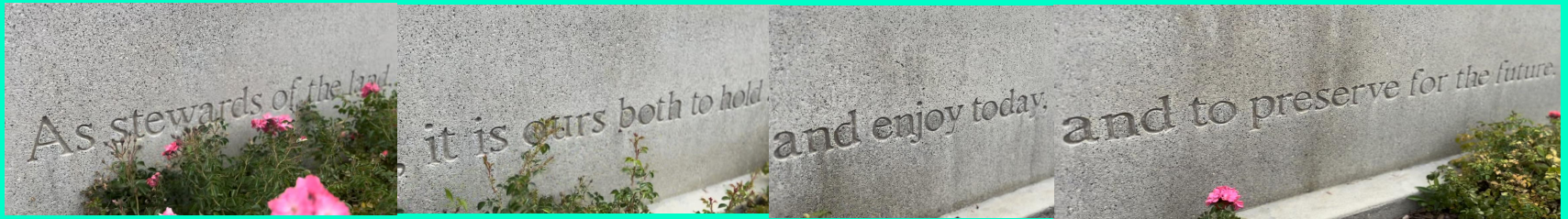

HOW CAN WE CREATE A JUST, HEALTHY, AND HUMANE WORLD? WHAT IS THE PATH TO DEVELOPING SUSTAINABLE ENERGY, FOOD, TRANSPORTATION, PRODUCTION, CONSTRUCTION, AND OTHER SYSTEMS? WHAT'S THE BEST STRATEGY TO END POVERTY AND ENSURE THAT EVERYONE HAS EQUAL RIGHTS? HOW CAN WE SLOW THE RATE OF EXTINCTION AND RESTORE ECOSYSTEMS? HOW CAN WE LEARN TO RESOLVE CONFLICTS WITHOUT VIOLENCE AND TREAT OTHER PEOPLE AND NONHUMAN ANIMALS WITH RESPECT AND COMPASSION? THE ANSWER TO ALL THESE QUESTIONS LIES WITH ONE UNDERLYING SYSTEM—SCHOOLING. TO CREATE A MORE SUSTAINABLE, EQUITABLE, AND PEACEFUL WORLD, WE MUST REIMAGINE EDUCATION AND PREPARE A GENERATION TO BE SOLUTIONARIES—YOUNG PEOPLE WITH THE KNOWLEDGE, TOOLS, AND MOTIVATION TO CREATE A BETTER FUTURE. WE MUST TRANSFORM EDUCATION AND TEACHING; CREATE SUCH A GENERATION; AND BUILD SUCH A FUTURE. -ZOE WEIL

WHY?

VISION, RENDERINGS, AND APPROVAL

Dale Jones envisioned outdoor learning areas for Guadalupe Elementary and gathered all of the input from the stakeholders.

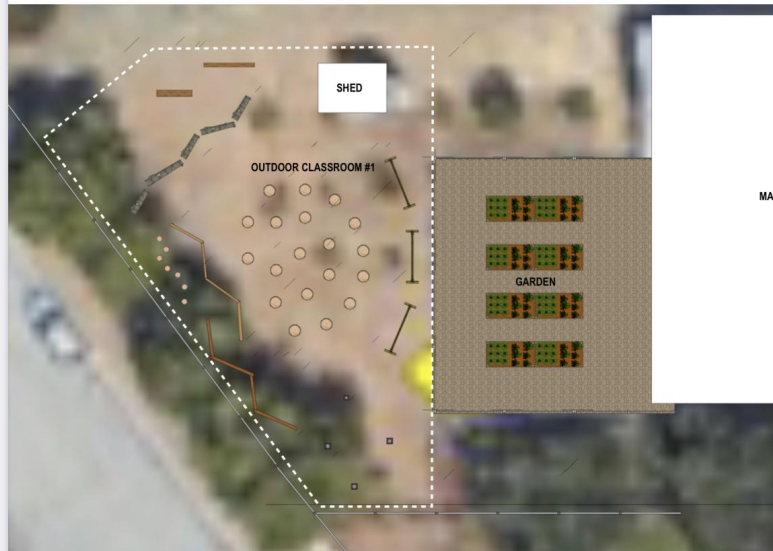

GUADALUPE ELEMENTARY OUTDOOR CLASSROOM #1
SITE PLAN
NOT TO SCALE



GUADALUPE ELEMENTARY OUTDOOR CLASSROOM #2
PERSPECTIVE VIEW
NOT TO SCALE

Jason Hull (architect and parent) brought Dale Jones' (former Principal) vision alive with the above renderings. There are many more renderings! They presented them to the stakeholders to acquire approval from Union School District. Dale calculated the amounts and acquired the funding from the Guadalupe Home and School Club.

Original Outdoor Learning Space Proposal

GUADALUPE GRIZZLIES GREAT OUTDOORS



Why Outdoor Learning?

"Outdoor learning has the power to connect newly acquired concepts and ideas to the physical world, reinforcing and enhancing learning. Being outside also benefits health, social-emotional growth, and learning."

- Principal Jones





THE GROVE 1



THE PRAIRIE 2

START WITH WHAT'S THERE...



- Direct engagement with the outdoor environment
- Transforming skills, knowledge, attitudes and behaviors
- Hands-on, play is critical and learn about themselves, each other and the world with the environment
- Academic achievement, personal & social development, employability, wellness & mental health
- Linking curriculum and learning experiences to real-world contexts of place and community. Can't be "taught" in a classroom

















LOGISTICS

Ashley Failing (parent and former educator) and Principal Dale Jones worked on pricing and purchasing the items. They worked through the logistics of the actual physical spaces to complete the designs (i.e. lack of ongoing maintenance in the garden, fire lanes, ordering, pricing, etc). Dale and Ashley collaborated continuously in the rollout of each of the items added to the areas.

IF WE WANT A GENERATION THAT CARES ABOUT THE ENVIRONMENT WE NEED TO ENCOURAGE A DEEP RELATIONSHIP WITH THE WORLD AROUND US (NOT JUST SCREENS). IN THIS WAY WE LEARN THAT WE ARE NOT SEPARATE FROM OUR SURROUNDINGS, BUT ACTIVE PARTICIPANTS IN IT'S VERY PROCESS AND EVOLUTION.
-KERI SMITH

February 4, 2022

These images show the condition of the space at the beginning of the project.



"If we want children to flourish, to become truly empowered, then let us allow them to love the earth before we ask them to save it."
David Sobel

REIMAGINING WHAT THE GARDEN AND OUTDOOR LEARNING MEANS

*The Environmental Principles and Concepts need to be incorporated in all future state adopted texts and instructional materials. Therefore, in 2016, the EP&Cs were integrated into the new California history - social science standards, new science standards and health frameworks (rolled out by 2019). So subsequent state adoption textbooks would integrate EP&Cs . Furthermore, the Common Core 3 State Standards for state of California were to **equip students with the right analytical and problem solving tools to problem solve the future environmental problems.** <https://tenstrands.org/eeicurriculum/curriculum/>*

LED TO THE ROLLOUT OF THE FOLLOWING

Santa Clara County  Office of Education

GROWING GARDENS Survey Analysis and Report

https://drive.google.com/file/d/1PZibmLc0qjQPfmgU_hMOWnNFxcpgb0uxF/view



Santa Clara County Office of Education
Environmental Literacy
Landscape Analysis & Report
2019

<https://www.sccoe.org/isteam/Documents/Santa%20Clara%20County%20Office%20of%20Education%20Environmental%20Literacy%20Survey%20Report.pdf>

ASHLEY IS ACTIVE WITHIN THE WEBINAR COMMUNITY FOR THE FOLLOWING:

- GARDEN AND ENVIRONMENTAL LITERACY
- THERAPY AND SENSORY GARDENS
- STEAM/ENVIRONMENTAL LITERACY
- THE US DEPARTMENT OF EDUCATION GREEN SCHOOLS

JOINED THE COLLABORATIVES WITH SANTA CLARA COUNTY OFFICE OF EDUCATION

Guadalupe is represented at the monthly meetings with the Growing Gardens Community of Practice, the Community Partner Collaborative, and all local Environmental Literacy conferences. The fifth grade teachers joined the Environmental Literacy Leadership Collaborative for Teachers! The Santa Clara County Office of Education wants to bring more stakeholders out to see what is happening at our school!

Growing Gardens Community of Practice

Program Overview

The Santa Clara County Office of Education's *Growing Gardens Community of Practice* is a network of TK-12 educators, TOSAs (Teachers on Special Assignment), administrators, garden coordinators, maintenance and operations, after school garden education providers/staff, volunteers & Community Partners.

During this Community of Practice we will:

- Collaborate and network with colleagues who support school gardens and/or outdoor learning spaces
- Explore partnerships to create and maintain sustainable systems for school gardens and/or outdoor learning spaces
- Share resources and ideas about the creative use of school gardens and outdoor learning spaces for both academic instruction and social emotional learning
- Learn about the best practices for designing, developing and maintaining school gardens and/or outdoor learning spaces.

*LED by a leading expert in Sustainability Education and also the Santa Clara County of Education Science Team

Environmental Literacy Leadership Collaborative

Santa Clara County Office of Education Environmental Literacy, Sustainability, & Climate Action

Board Resolution- 12-15-21

CEL/CREEC

Growing Gardens Project

Nature Journaling Conference- 2020

SCCOE Community Based Partner Hub

Walden West

*LED by Santa Clara County of Education Science/STEAM Coordinators

GATHERED THE IDEAS

SOUGHT GUIDANCE FROM COMMUNITY PARTNERS AND ENVIRONMENTAL LITERACY EDUCATORS FROM ACROSS THE GLOBE



ENVIRONMENTAL VOLUNTEERS
Inspiring a love of science and nature



IMPLEMENTED IDEAS

We connected the spaces to the latest Environmental Literacy trends and standards, wrote grants, and worked on the practicality of connecting it to STEAM concepts.

G
A
R
D
E
N

O
L
A

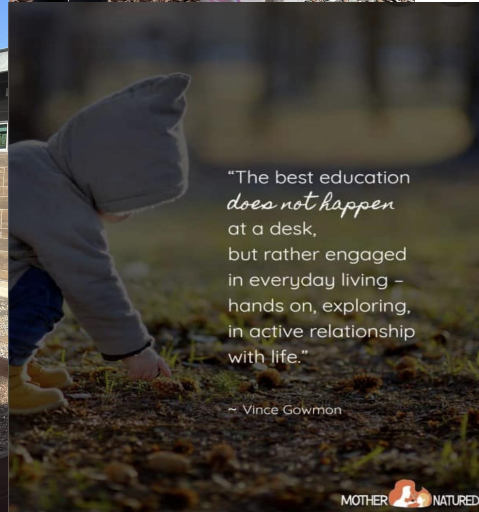

"The best education
does not happen
at a desk,
but rather engaged
in everyday living –
hands on, exploring,
in active relationship
with life."

~ Vince Gowman

OUR GUADALUPE COMMUNITY SHOWED UP!

THANK YOU, THANK YOU, THANK YOU!!!





SO MANY DONATIONS OF TIME, SUPPLIES, AND RESOURCES HAVE COME FROM OUR COMMUNITY AND BEYOND!

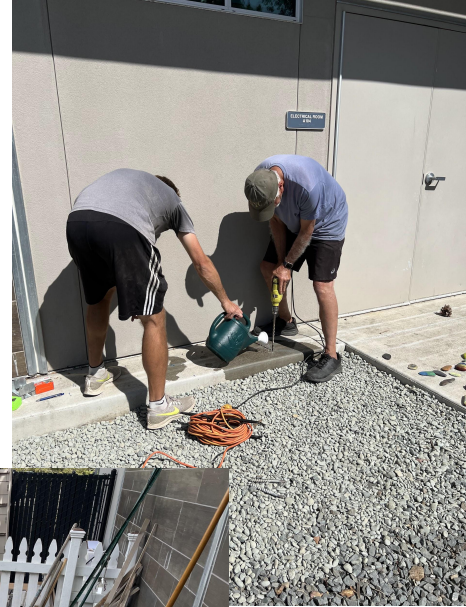
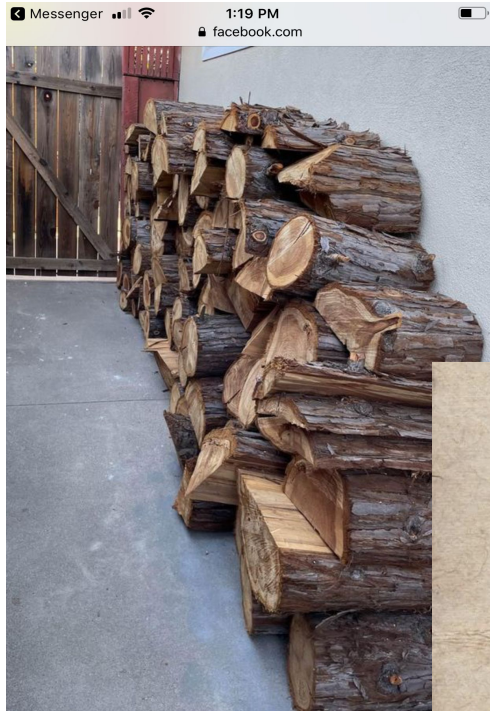

"We don't need a handful of people doing zero waste perfectly. We need millions of people doing it imperfectly."

- Ann Marie Bonneau



GUADALUPE ELEMENTARY SCHOOL



HAS BEEN
AWARDED

THE HAPPY HOLLOW ZOO AND PARK GRANT

FOR BEING A

PROGRESS FOR POLLINATOR CONSERVATION SPACE IN 2022!!

Project design should incorporate the themes of conservation, creativity, and fun.

Project must contain a teaching component, with a signage installation or personal interpretation, that educates the community about native pollinators and native plants.

CURRENT ROLLOUT FALL 2022:

GARDEN PLANTING AND EXPLORATION

Acknowledge the Past



THIS IS OHLONE LAND

Acknowledge the Past

Plant with a Purpose

Plan for the Future

Guadalupe Elementary School

Garden Planting Sessions



Pollinator Station



Art Exploration



Sensory Garden Exploration



Watercolor a leaf

Investigation Station



Water Play



Guess it, Weigh it, Test it!



Creation Station



EXPLORING THE SPACES



PLAYGROUND OLA

COMING: WINTER 2023



A family donated all of the surrounding rocks and boulders, and then moved and installed them on Community Day.



A family donated cobblestones that were pulled from the streets of San Francisco after the 1906 Earthquake.

NEXT WAVE OF ELEMENTS TO BE ADDED SOON:
GLOCKENSPIEL, BALANCE BEAMS, WALKING PATH/SITTING SPOTS, TAN BARK, LARGE PEBBLE DIG PIT (DONE), A BRIDGE, NATIVE PLANTS AND TREES (Spring 2023), and 10 MORE BOULDERS WERE FROM A FAMILY (added after this update)

FUTURE OF PLAYGROUND OLA

CURRENTLY, THE OLA TEAM (ASHLEY AND BRIAN FAILING) ARE WORKING ON THE FOLLOWING:

- WRITING GRANTS
- PRINCIPAL BAROCIO AND ASHLEY ARE CLOSELY WORKING WITH ALL OF THE STAKEHOLDERS TO HELP CREATE SPACES CONNECTED TO THE LEARNING
- WORKING ON PROPOSALS FOR A NATIVE GRASS AND RAIN GARDEN TO REDUCE RUNOFF ON THE HILL AND PROVIDE NATURAL PLAYSAPES. WE PLAN TO PLANT MATURE TREES AND INSTALL DRIP IRRIGATION IN 2023.

FUTURE OF GARDEN OLA

CURRENTLY,

- ASHLEY FAILING, DANIELLE VIGIL, AND KATIA STRELNIKOVA ARE WORKING TOGETHER TO GET THE GARDEN PROGRAM RUNNING FOR ALL STUDENTS.
- ASHLEY RECREATED WHAT THE GARDENING CURRICULUM AND WHAT THE PLANTING SCHEDULE MEANS AT GUADALUPE FOR THE 2022-2023 ROLLOUT.
- THE GHSC- FUNDED OLA TEAM CONTINUES TO WORK ON GRANTS AND CONNECTING WITH TEACHERS BASED ON REQUESTS AND NEEDS.
- THE GHSC-FUNDED GARDEN PROGRAM IS WORKING ON FINISHING FALL PLANTINGS IN OCTOBER 2022 AND WILL WORK ON JOINTLY COLLABORATING WITH VOLUNTEERS TO HAVE THREE PLANTING CYCLES A YEAR FOR ALL STUDENTS.
- THERE WILL BE A MONARCH BUTTERFLY WAYSTATION ADDED IN THE SPRING OF 2023 AND COMPOSTING WILL START IN THE FALL OF 2022. THE SENSORY GARDEN WILL BE COMPLETED BY MARCH 2023.

EMAIL QUESTIONS: OLA.GHSC@GMAIL.COM

A BIG THANK YOU GOES TO EACH AND EVERY PERSON THAT HAS SHOWN UP TO BE PART OF THE CHANGE!